

Encountering IEDs: Pre-Blast

SECURITY – Maintain 360 degrees. Scan close in and far out, up high and down low.

ALWAYS – Scan your immediate surroundings for more IEDs.

MOVE – Move away. Vary safe distances, but plan for 300m minimum safe distance and adapt to your METT-TC.

ATTEMPT – To confirm suspected IEDs using optics while staying back as far as possible.

CORDON – Off the area. Direct people out of danger area. Do not allow anyone to enter except for Explosive Ordnance Disposal (EOD). Question, search and detain suspects as defined by your existing ROE.

REPORT – Your situation using the 9-line IED/UXO spot report format.

Do not pull wires.

Do not handle or disturb suspicious items.

Do not cut wires.

Always call EOD when in doubt.

Encountering IEDs: Post-Blast

IMPORTANT: DO NOT FOCUS ON THE DEVICE THAT HAS BEEN FOUND OR JUST GONE OFF!

Move out of the kill zone.

Initiate immediate and aggressive response to IED attacks in accordance with ROE.

Search for/clear additional IEDs (5m & 25m).

Look for triggerman.

Look for anyone trying to escape the area either armed or unarmed.

Detain personnel found with commonly used detonation devices such as cordless phones, key fobs or radios and test them for bomb residue.

Be alert for approaching VBIEDs and enemy maneuvering to engage with small arms and RPGs.

Treat/evacuate casualties.

5 & 25 Meter Scan

CLEAR CONFIRM CORDON CONTROL CHECK
AREA EOD AREA PERIMETER SECONDARIES

Always conduct 5/25-meter check to avoid stopping near kill zone of an IED. Scan outward continuously at all times. Driver/gunner should remain inside vehicle for security purposes.

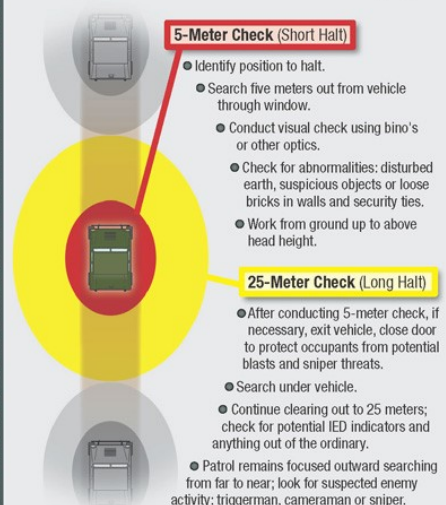

IED Reminders!

ON PATROL

Be proactive!

Consider each patrol as if it is your first. Maintain situational awareness, environmental understanding and common sense.

Be the hunter not the hunted—project a strong image!

Don't enter a front door or gate if you can do a tactical call-out (might be booby-trapped).

Don't get complacent!!!

Don't set patterns. Stay in constant motion.

Don't fixate on casualties! Eliminate the threat first!

HUMINT

Know your turf: Build a mental model of the people, topography, economy, history, religion and culture of your AO.

Diagnose the problem: Understand the locals, how/why they support insurgents, how to mobilize the population.

Master Information Operations: Inform, influence, assess
Photograph enemy/EPW: With evidence for prosecution.

MEDICAL PREPAREDNESS

Carry extra medical supplies—IFAK not enough.

Carry extra tourniquets—one in reach of each hand.

Develop leaders to lowest level to take charge if you go down.

Continually practice lifesaving skills and training. INVEST IN YOUR LIFE!

Safe Stand-Off Distance Cheat Sheet

HIGH EXPLOSIVES				
	Pipe Bomb	25 m	260 m	
	Briefcase Bomb	50 m	575 m	
	Suicide Vest or Belt	35 m	425 m	
	Car	125 m	535 m	
	Van	200 m	850 m	
	Small Truck	275 m	1150 m	
	Water Truck	375 m	2000 m	
	Semitrailer	475 m	2200 m	
LIQUEFIED PETROLEUM-LPG				
	LPG Tank	15 m	50 m	
	Large LPG Tank	25 m	100 m	
	Small LPG Truck	90 m	375 m	
	Large LPG Truck	155 m	625 m	

Source: U.S. Army National Ground Intelligence Center (NGIC). Distances rounded up for safety and usability.

Encountering IEDs: Pre-Blast

Always alert unit when IED has been spotted.

ROADSIDE IED

- Evacuate danger area and move to tactically safe distance.
- Establish security. Scan for possible secondary IEDs/signs of enemy activity.
- Report IED and any secondary IEDs to patrol leadership.

VBIED — VEHICLE-BORNE IED

- Signal approaching vehicle to maintain maximum standoff.
- If vehicle continues approaching, point your weapon at it and demonstrate intent to use it.
- If vehicle becomes immediate threat, fire aimed warning shots.
- If vehicle continues, fire aimed shots at engine block.
- If vehicle still continues, use deadly force in accordance with ROE and EOD.
- Clear the area, establish security and scan for other signs of enemy activity.

PBIED — SUICIDE BOMBER

- If bomber sees he/she has been detected, prepare for attempted detonation.
- Do not attempt to restrain suspect.
- For compliant suspect: remove to secure area with weapon at ready position—do not approach.
- For non-compliant suspect: use deadly force IAW ROE.

Copyright©2008 Kwikpoint

IED/UXO Report

DATE-TIME-GROUP (DTG): DTG item was discovered.

REPORTING ACTIVITY: (unit identification code (UIC)) and location (grid of UXO).

CONTACT METHOD: Radio frequency, call sign, Point Of Contact (POC) and telephone number.

TYPE OF ORDNANCE: Dropped, projected, placed or thrown. If known, give the size of the hazard area and number of items. Without touching, disturbing, or approaching (tripwire) the item, include details about size, shape, color and condition (intact or leaking).

NBC CONTAMINATION: If present, be as specific as possible.

RESOURCES THREATENED: Report any threatened equipment, facilities or other assets.

IMPACT ON MISSION: Provide a short description of your current tactical situation and how the presence of the UXO affects your status.

PROTECTIVE MEASURES: Describe any measures taken to protect personnel and equipment.

RECOMMENDED PRIORITY: Recommend a priority for response by EOD technicians or engineers.

- IMMEDIATE:** Stops unit's maneuver and mission capability or threatens critical assets vital to the mission.
- INDIRECT:** Slows the unit's maneuver and mission capability or threatens critical assets important to the mission.
- MINOR:** Reduces the unit's maneuver and mission capability or threatens non-critical assets of value.
- NO THREAT:** Has little or no effect on the unit's capabilities or assets.

New IED Techniques

Use of IRAMs:
Improvised Rocket-Assisted Mortars



Use of HME:
Home-Made Explosives



Use of multiple EFPs:
Explosively-Formed Penetrators

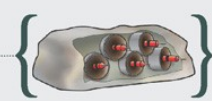

Traffic cones or construction material in construction areas hide IEDs.

Children are used to deliver IEDs.

VBIED drivers wear PPE-type armor for protection.

Suicide bombers wait for mobile target and follow it.

IED with booster charge to propel into the air before detonation.

Pressure detonated IEDs.

Use of Passive Infrared (PIR) in conjunction with EFPs.

Dual-initiated IED in the event the attacker hesitates.

IED Reminders!

Every soldier is a sensor!

Report tactical observations and information.

On mounted patrol use your CREW device!

CREW is as important as your armor and weapon. "FIGHT WITH IT, NOT AGAINST IT"

Break the electronic link between the IED and the trigger (triggerman).

KNOW HOW TO:

- Put the CREW into operation.**
- Conduct pre-combat checks and maintenance.**
- Conduct CREW checks while in operation:**
 - Place radio on SCAN to pick up enemy communication.
 - Change your TTP each time you stop for IEDs.
 - Avoid tunnel vision; watch your flanks and rear.
 - Attacks are often videotaped, look for the cameraman.

Stay away from UXOS/IEDS!

You could lose your hand if you try to dispose of UXOs or IEDs. The enemy has developed anti-handling to catch you when you try defusing. Leave it to the experts.

Call EOD—Don't be a hero!



Islamic Extremism

AL QAIDA

Transnational Islamic terrorist network responsible for attacks on US and foreign civilian/military targets since the 1990s. Now operate in collaboration with the Taliban.

Typical tactics include suicide bombings, simultaneous bombings of different targets and ambush of its enemies.

Training camps located in Afghanistan, Iraq, Pakistan, Sudan. Source of ideological inspiration and guidance for terrorists worldwide.

TALIBAN

Radical Sunni Islamist and Pashtun nationalist movement. Ruled most of Afghanistan from 1996 to 2001, supported with arms/training/financing from Pakistan, Saudi Arabia, and other Middle Eastern countries.

Follows hybrid, extremely strict interpretation of Islamic law, combined with Wahhabism (see below) and other local ideologies and customs.

Notorious for human rights abuses, but removed from power in 2001 by coalition of Afghan Northern Alliance and NATO.

Currently engaged in protracted guerilla war against the current government of Afghanistan, Operation Enduring Freedom and the NATO-led ISAF.

WAHHABISM / WAHHABISTS / WAHHABIS

Extreme form of Islam known for strict moral and religious doctrine that strives to purify Islamic beliefs and rejects any innovations after 3rd century of Islam (9th Century A.D.). Dominant form of Islam practiced in Saudi Arabia. Some adherents support Al Qaida.